

A-A剖面

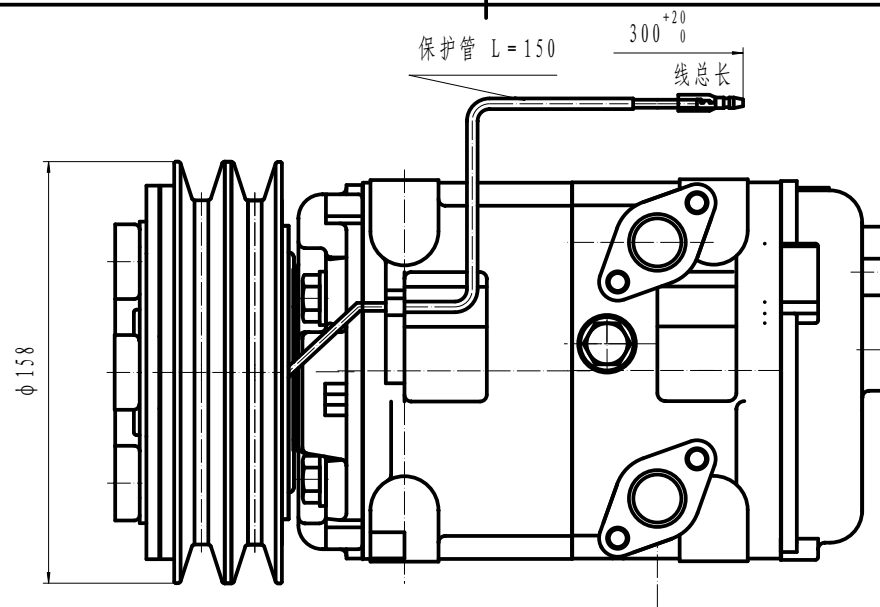

- COMPRESSOR ASSY:
1. OPERATING: 700~5000r/min (MAXIMUM SPEED 6000r/min)
 2. DIRECTION OF ROTATION: CLOCK WISE
 3. WEIGHT: 15.5kg
 4. REFRIGERANT: HFC-134a
 5. LUBRICANT: PAG 500TMcm³
 6. WEIGHT: 9.5kg (WITHOUT OIL)

- MAGNETIC CLUTCH:
1. RATED VOLTAGE: DC 24V
 2. SHAPE OF THE BELT: 2B
 3. STATIC TORSION: ABOVE 78N.m (8kgf.m)
 4. WATTAGE: 48W (DC24V2.0A) (25°C)
 5. MINIMUM ATTRACTING VOLTAGE: BELOW 21V (V_L) (90°C)
 6. WEIGHT: 5.5kg

- COMPRESSOR:
1. MODEL: HCS-33
 2. CYLINDER: 10- ϕ 37X30.7
 3. DISPLACEMENT: 330cm³/rev
 4. LEAKAGE TEST: ADDITIONAL TABLE
 5. GAS LEAK: 30g/y

- NOTE FOR COMPRESSOR INSTALLATION:
1. INCLINATION AT INSTALLATION SHOULD BE <math>< 15^\circ</math> IN LATERAL DIRECTION; <math>< 5^\circ</math> FOR FRONT LIFTING; AND NO LIFTING FOR BACKSIDE;
 2. DURING TRANSPORTATION, COMPRESSOR SHOULD NOT BE INCLINED BY 45° IN BOTH LATERAL AND LONGITUDINAL DIRECTIONS; BEFORE INSTALLATION, COMPRESSOR SHOULD BE PLACED HORIZONTALLY FOR MORE THAN 10 MINUTES;
 3. REQUIREMENTS FOR THE BOLT TORSIONS:
FIXED BRACKET BOLT: 36-50N.M
FIXED LINKER BOLT: 20-24N.M

ITEM	UNIT	HIGH PRESSURE SIDE	LOW PRESSURE SIDE
		MPa	MPa
AIRPROOF PRESSURE	MPa	2.9	1.5
	(kgf/cm ² G)	(30)	(15)
RESISTANT PRESSURE	MPa	4.4	2.2
	(kgf/cm ² G)	(45)	(22.5)

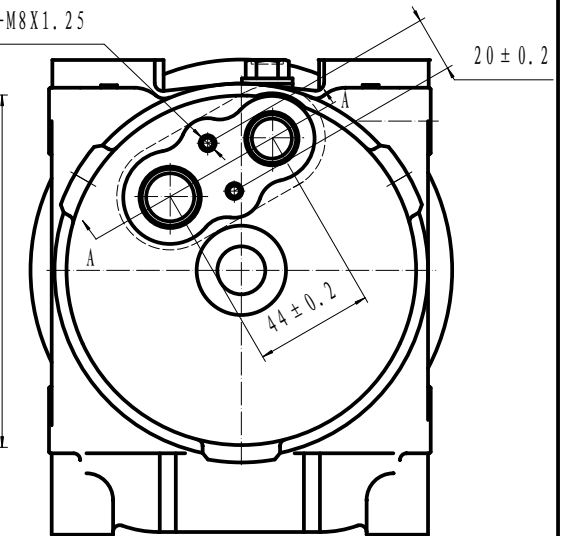
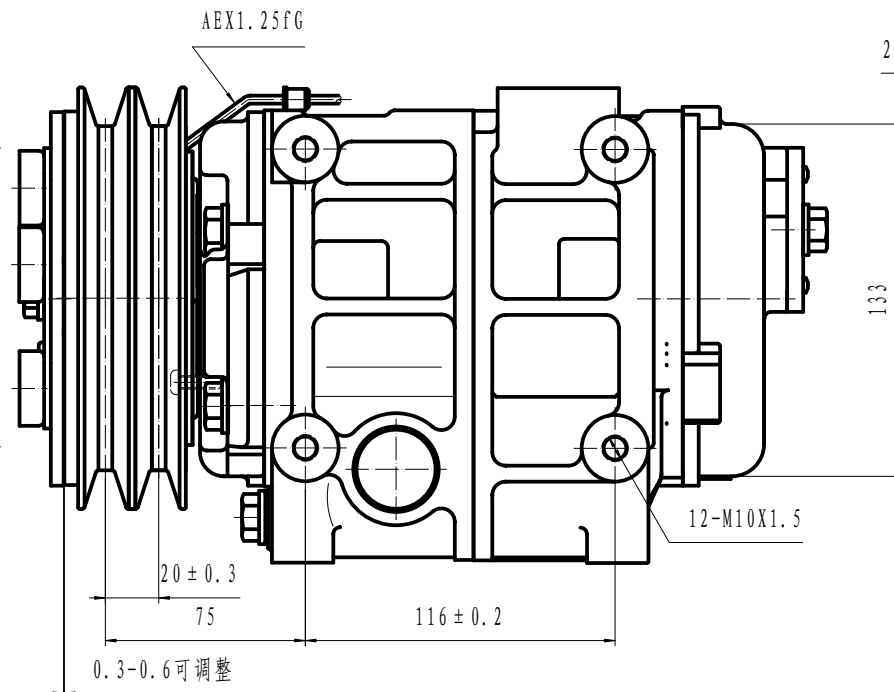
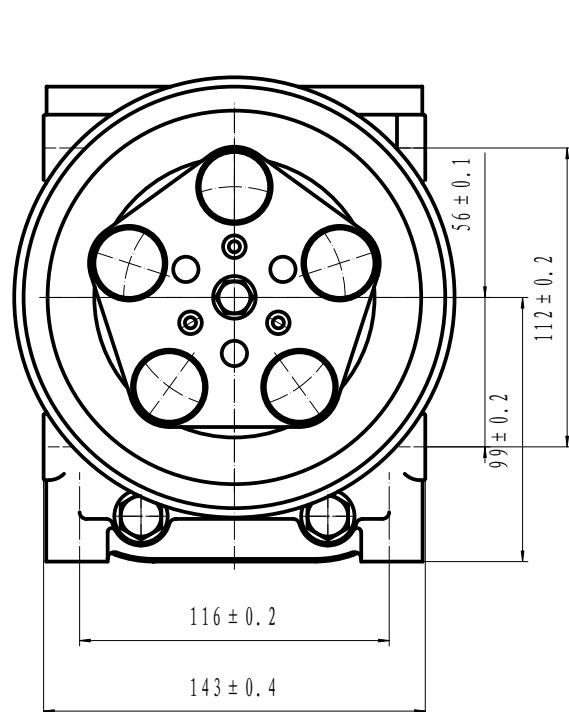

						HCS-33		重庆华之龙汽车制冷设备有限公司	
图号	01	7	图名	总装图	09-02-03	图样标记	共 1 张	第 1 张	
比例	1:1								
工艺	305160-5000								

总装图