

A-A剖面

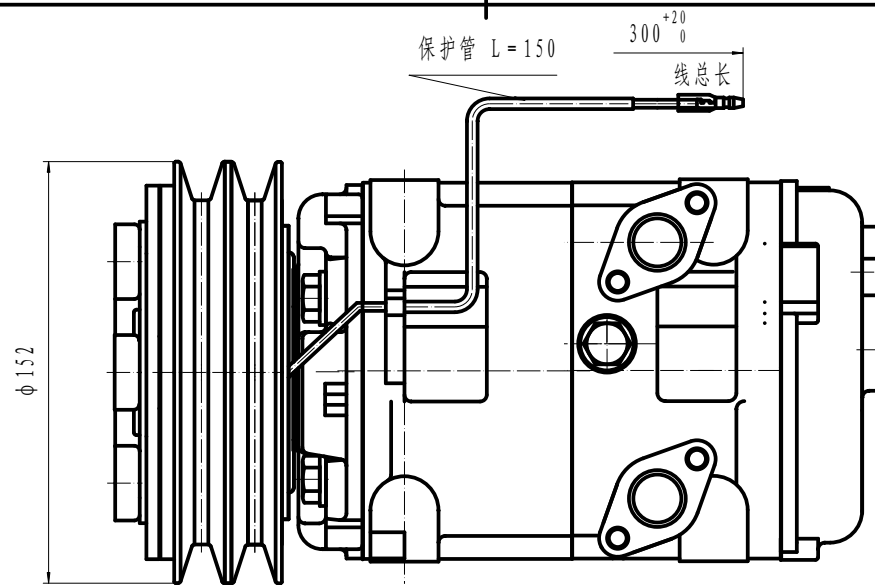

- COMPRESSOR ASSY:
1. OPERATING SPEED: 700~5000r/min (MAXIMUM SPEED 6000r/min)
 2. DIRECTION OF ROTATION: CLOCK WISE
 3. WEIGHT: 15.5kg
 4. REFRIGERANT: HFC-134a
 5. KYBUICANT: PAG 500TMcm³
 6. WEIGHT: 9.5kg (WITHOUT OIL)

- COMPRESSOR:
1. MODEL: HCS-33
 2. CYLINDER: 10- $\phi 37 \times 30.7$
 3. DISPLACEMENT: 330cm³/rev
 4. LEAKAGE TEST: ADDITIONAL TABLE
 5. GAS LEAK: 30g/y

- MAGNETIC CLUTCH:
- 1 RIBTED VOLTAGE: DC 24V
 - 2 SHAPE OF THE BELT: 2A
 - 3 STATIC TORSION: ABOVE 78N.m (8kgf.m)
 - 4 WATTAGE: 48W (DC24V2.0A) (25度)
- MINIMUM ATTRACTING VOLTAGE:
BELOW 21V (90度)
- 5 THERMAL RESISTANCE:
AT 100度, DC50VELECTRIFY SUCCESSIVELY
 - 6 WEIGHT: 5.5kg

- NOTE FOR COMPRESSOR INSTALLATION:
1. INCLINATION AT INSTALLATION SHOULD BE <math>< 15^\circ</math> IN LATERAL DIRECTION; <math>< 5^\circ</math> FOR FRONT LIFTING; AND NO LIFTING FOR BACKSIDE;
 2. DURING TRANSPORTATION, COMPRESSOR SHOULD NOT BE INCLINED BY 45° IN BOTH LATERAL AND LONGITUDINAL DIRECTIONS; BEFORE INSTALLATION, COMPRESSOR SHOULD BE PLACED HORIZONTALLY FOR MORE THAN 10 MINUTES;
 3. REQUIREMENTS FOR THE BOLT TORSONS:
FIXED BRACKET BOLT: 36-50N.M
FIXED LINKER BOLT: 20-24N.M

ITEM	UNIT	HIGH PRESSURE SIDE	LOW PRESSURE SIDE
		AIRPROOF PRESSURE	MPa (KgF/cm ² G)
RESISTANT PRESSURE	MPa (KgF/cm ² G)	4.4 (45)	2.2 (22.5)

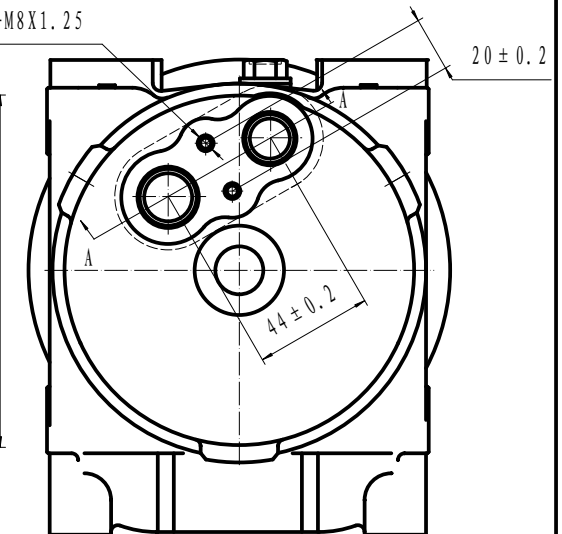
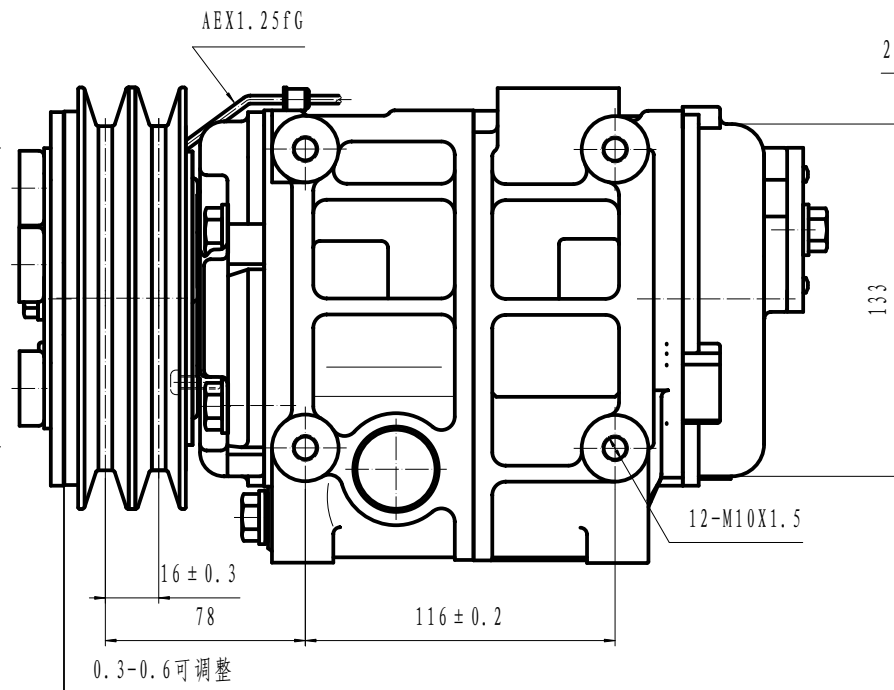
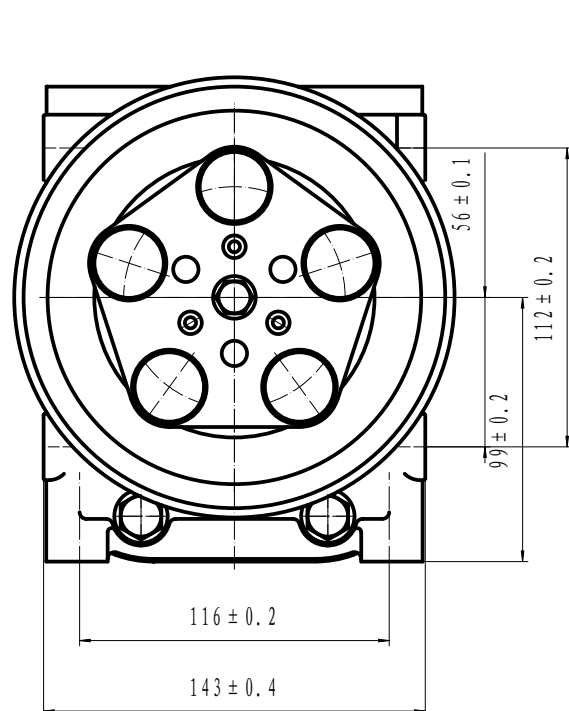

						HCS-33		重庆华之龙汽车制冷设备有限公司	
版次	数量	合计	使用文件号	零件	年月	修改标记		数量	
版次	01	7	标准号	标准号	09-02-04			比例	
审核								1:1	
工艺								305160-5010	

总装图